



# ALKALINE DEGREASER

## INDUSTRIAL DEGREASER EMULSIFIER

**Instantly Emulsifies  
Oily Soils**

**Patented Formula  
Produces Fast,  
Economical Cleaning**

**Solvent Free Formula  
is Safer for Workers  
and the Environment**

**Contains Corrosion  
Inhibitors—Safe on  
Most Industrial  
Surfaces and  
Equipment**

### Professional Recommendations

- This is an excellent “catch-up” cleaner that will perform best when used regularly
- **Use** "grit" type brushes on your autoscrubber to enhance cleaning on unfinished concrete and other industrial floors
- Overlap your cleaning passes to assure uniform cleaning and "double scrub" when heavy soil is present
- When mop cleaning, change cleaning solution frequently to get peak cleaning performance. Do not let mop rest in cleaning solution between uses.
- If applying with a pressure washer, stay out of mist
- **Not** recommended for removal of baked-on or dried, hardened soils—use a cleaner that is solvent fortified

### Specifications

Appearance	Clear, red liquid
Density (lbs/gal)(±0.1 @20°C)	8.98
pH (Conc./1%)(±0.5 @20°C)	13.5/11.2
BRIX activity,% (±0.5 @20°C)	14.0
Hard water tolerance (hardness as ppm CaCO <sub>3</sub> )	Greater than 2100 ppm
Total alkalinity (% CaCO <sub>3</sub> )	6.7
% Volatile organic compounds (VOC)	0.0
Foam generation	Moderate
USDA rating	A-1
Stability (40°-120°F)	Stable
Freeze/thaw stability	OK 3 cycles
Shelf life (Closed containers, 40°-120°F)	1 year minimum
D.O.T. classification	Corrosive

### Equipment List

- ✓ Wet floor signs
- ✓ Autoscrubber with grit type brushes
- ✓ Wet vacuum
- ✓ Looped-end cotton mop
- ✓ Mop bucket with wringer
- ✓ Pressure washer
- ✓ Push broom

### Available In Sizes

Quart	AC00734
5 Gallons	AC00735
55 Gallons	AC00736

Wear safety equipment recommended on MSDS, place wet floor signs and read all directions and cautions prior to beginning work.



Wear safety equipment recommended on MSDS. Read all directions and cautions prior to beginning work. Remove loose soil and garbage. Divide floor into workable sections.

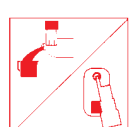

Dilute **Alkaline Degreaser** with water as follows:  
 Heavy soil: 5:1 (26 oz. per gallon)  
 Moderate soil: 20:1 (6 oz. per gallon)  
 Light cleaning: 50:1 (2.5 oz. per gallon).



Apply to surface liberally while scrubbing. Allow to work. If soil is heavy, double scrub with an autoscrubber (First pass, squeegee up; second pass, squeegee down, vac on). Pick up as much solution as possible. If possible, allow floor to dry before traffic resumes on cleaned area.



For Pressure Cleaning: Draw concentrate directly from container. Set dilution using pressure washer manufacturer's directions according to soil present.

